

Item	Part Number	List Price	Specifications	Dimensions
------	-------------	------------	----------------	------------

DOOR ACCESSORIES

BR7001

S Knocker



- 9BR7001-001** Venetian Bronze 112
- 9BR7001-002** Satin Nickel 150
- 9BR7001-003** Polished Chrome 260
- 9BR7001-004** Polished Brass 003
- 9BR7001-005** Matte Antique Nickel 152
- 9BR7001-006** Matte Brass & Black 049
- 9BR7001-009** Polished Nickel 141

\$52.00

- Solid brass construction
- Available as a complete set with mounting hardware, installation instructions and drill template
- Mounted with through-holes and fits 1-3/4" doors
- Uses 10-24 thru-bolts

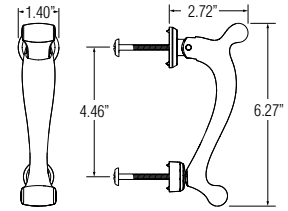

BR7002

Contemporary Knocker



- 9BR7002-001** Venetian Bronze 112
- 9BR7002-002** Satin Nickel 150
- 9BR7002-003** Polished Chrome 260
- 9BR7002-009** Polished Nickel 141

\$52.00

- Solid brass construction
- Available as a complete set with mounting hardware, installation instructions and drill template
- Mounted with through-holes and fits 1-3/4" doors
- Uses 10-24 thru-bolts

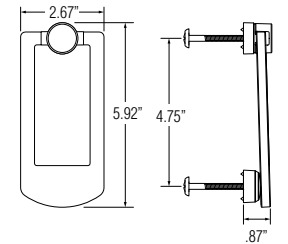

BR7003

Ring Knocker



- 9BR7003-001** Venetian Bronze 112
- 9BR7003-002** Satin Nickel 150
- 9BR7003-003** Polished Chrome 260
- 9BR7003-004** Polished Brass 003
- 9BR7003-005** Matte Antique Nickel 152
- 9BR7003-006** Matte Brass & Black 049
- 9BR7003-007** Dark Bronze 481
- 9BR7003-008** White Bronze 492
- 9BR7003-009** Polished Nickel 141

\$52.00

- Solid brass construction
- Available as a complete set with mounting hardware, installation instructions and drill template
- Mounted with through-holes and fits 1-3/4" doors
- Uses 10-24 thru-bolts

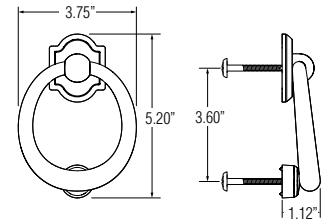

BR7015

Rectangular Bell Button



- 9BR7015-001** Venetian Bronze 112
- 9BR7015-002** Satin Nickel 150
- 9BR7015-003** Polished Chrome 260
- 9BR7015-004** Polished Brass 003
- 9BR7015-005** Matte Antique Nickel 152
- 9BR7015-006** Matte Brass & Black 049

\$32.00

- Brass construction with concealed fasteners
- Illuminated button for easy detection at night
- Recommended for use with up to 24 volt transformers
- Available as a complete set with mounting hardware

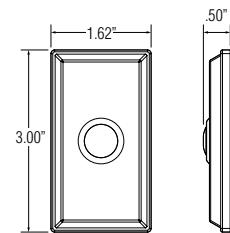

BR7016

Oval Bell Button



- 9BR7016-001** Venetian Bronze 112
- 9BR7016-002** Satin Nickel 150
- 9BR7016-003** Polished Chrome 260
- 9BR7016-004** Polished Brass 003
- 9BR7016-005** Matte Antique Nickel 152
- 9BR7016-006** Matte Brass & Black 049

\$32.00

- Brass construction with concealed fasteners
- Illuminated button for easy detection at night
- Recommended for use with up to 24 volt transformers
- Available as a complete set with mounting hardware

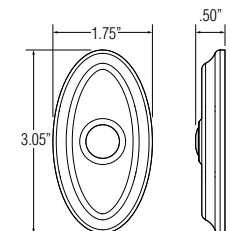

Item	Part Number	List Price	Specifications	Dimensions
------	-------------	------------	----------------	------------

DOOR ACCESSORIES

BR7017

Arch Bell Button



- 9BR7017-001** Venetian Bronze 112
- 9BR7017-002** Satin Nickel 150
- 9BR7017-003** Polished Chrome 260
- 9BR7017-004** Polished Brass 003
- 9BR7017-005** Matte Antique Nickel 152
- 9BR7017-006** Matte Brass & Black 049
- 9BR7017-007** Dark Bronze 481
- 9BR7017-008** White Bronze 492

\$32.00

- Brass construction with concealed fasteners
- Illuminated button for easy detection at night
- Recommended for use with up to 24 volt transformers
- Available as a complete set with mounting hardware

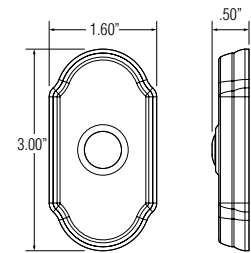

BR7004

Observascope



- 9BR7004-001** Venetian Bronze 112
- 9BR7004-002** Satin Nickel 150
- 9BR7004-003** Polished Chrome 260
- 9BR7004-004** Polished Brass 003

\$17.00

- Brass construction
- Provides one-way 170 degree angle visitor identification before entry
- Adjusts for use on 1.38" to 2.16" thick doors
- Bore hole diameter: 9/16"
- UL certified

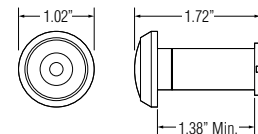

BR7012

Edge Pull



- 9BR7012-001** Venetian Bronze 112
- 9BR7012-002** Satin Nickel 150
- 9BR7012-003** Polished Chrome 260
- 9BR7012-004** Polished Brass 003
- 9BR7012-005** Matte Antique Nickel 152
- 9BR7012-006** Matte Brass & Black 049

\$15.00

- Brass construction
- Ideal for use on 1" or thicker doors
- Curved finger pull provides easy installation and use
- 1.32" pull projection

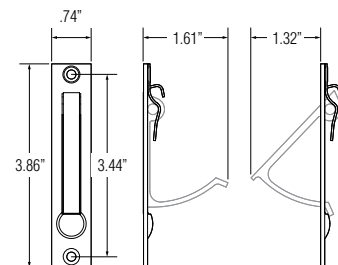

BR7018

Ball Catch



- 9BR7018-001** Venetian Bronze 112
- 9BR7018-002** Satin Nickel 150
- 9BR7018-003** Polished Chrome 260
- 9BR7018-004** Polished Brass 003
- 9BR7018-005** Matte Antique Nickel 152
- 9BR7018-006** Matte Brass & Black 049

\$18.50

- For use on louvered, bi-folding, accordion, closet and light to medium service doors
- Ball adjusts for door gap and latch tension
- Brass construction with steel ball
- Available as a complete set with mounting hardware

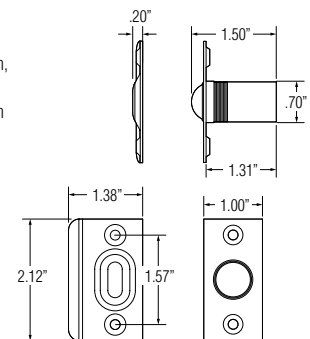

BR7020

Flush Bolt



- 9BR7020-001** Venetian Bronze 112
- 9BR7020-002** Satin Nickel 150
- 9BR7020-003** Polished Chrome 260
- 9BR7020-004** Polished Brass 003
- 9BR7020-005** Matte Antique Nickel 152
- 9BR7020-006** Matte Brass & Black 049

\$14.50

- Solid brass construction
- Features .94" extension bolt throw
- Smooth working action for easy operation
- Ideal for securing the inactive leaf of double doors
- Available as a complete set with strike, mounting hardware and installation instructions

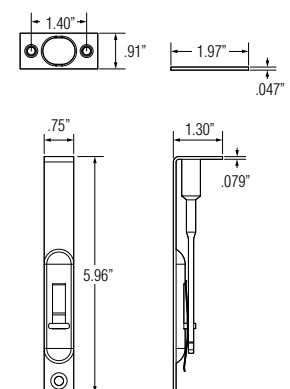

DOOR ACCESSORIES

BR7021
Surface Bolt 6"



9BR7021-001 Venetian Bronze 112
9BR7021-002 Satin Nickel 150
9BR7021-003 Polished Chrome 260
9BR7021-004 Polished Brass 003
9BR7021-005 Matte Antique Nickel 152
9BR7021-006 Matte Brass & Black 049

\$26.00

- Solid brass construction
- Ideal for securing doors, casement windows, cabinets and drawers
- Furnished with both universal and mortise strikes
- Solid brass mounting screws are concealed
- Features .69" extension bolt throw and .67" knob projection from door

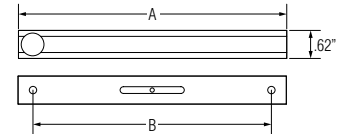
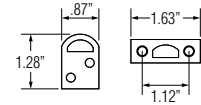

	A	B
Surface Bolt 6"	6"	5.25"
Surface Bolt 4"	4"	3.27"

BR7022
Surface Bolt 4"



9BR7022-001 Venetian Bronze 112
9BR7022-002 Satin Nickel 150
9BR7022-003 Polished Chrome 260
9BR7022-004 Polished Brass 003
9BR7022-005 Matte Antique Nickel 152
9BR7022-006 Matte Brass & Black 049

\$23.00

WINDOW HARDWARE

BR7013
Flush Pull



9BR7013-001 Venetian Bronze 112
9BR7013-002 Satin Nickel 150
9BR7013-003 Polished Chrome 260
9BR7013-004 Polished Brass 003
9BR7013-005 Matte Antique Nickel 152
9BR7013-006 Matte Brass & Black 049

\$17.00

- Brass construction
- For use on large or heavy sliding doors and panels
- Available as a complete set with mounting hardware and installation instructions

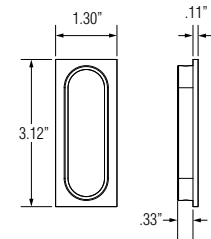

BR7014
Sash Lock



9BR7014-001 Venetian Bronze 112
9BR7014-002 Satin Nickel 150
9BR7014-003 Polished Chrome 260
9BR7014-004 Polished Brass 003
9BR7014-005 Matte Antique Nickel 152
9BR7014-006 Matte Brass & Black 049

\$18.00

- Solid brass construction
- Secures and helps prevent air movement around double hung windows
- Available as a complete set with mounting hardware

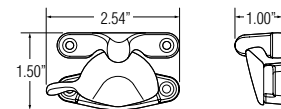

BR7019
Sash Lift



9BR7019-001 Venetian Bronze 112
9BR7019-002 Satin Nickel 150
9BR7019-003 Polished Chrome 260
9BR7019-004 Polished Brass 003
9BR7019-005 Matte Antique Nickel 152
9BR7019-006 Matte Brass & Black 049





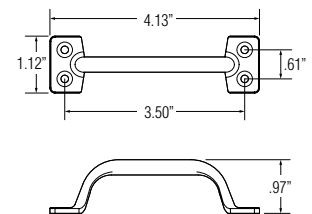

\$16.00

- Solid brass construction
- Ideal for use on double hung windows
- Can also function as a door, cabinet or drawer pull
- Projection: .97"
- Includes mounting hardware

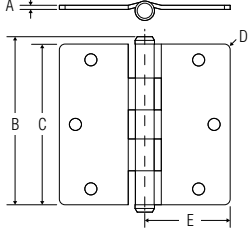

Item	Part Number	List Price	Specifications	Dimensions
DOOR STOPS				
BR7005 Rigid Door Stop 3" 	9BR7005-001 Venetian Bronze 112	\$12.00	<ul style="list-style-type: none"> • Brass construction • Heavy design helps prevent damage to walls • Pre-installed stud and slotted tip for easy installation 	
	9BR7005-002 Satin Nickel 150			
	9BR7005-003 Polished Chrome 260			
	9BR7005-004 Polished Brass 003			
	9BR7005-005 Matte Antique Nickel 152			
	9BR7005-006 Matte Brass & Black 049			
BR7006 Wall Bumper 1" (Convex) 	9BR7006-001 Venetian Bronze 112	\$13.00	<ul style="list-style-type: none"> • Brass collar • Convex surface with durable rubber bumper for long operating life • Includes mounting hardware and installation instructions 	
	9BR7006-002 Satin Nickel 150			
	9BR7006-003 Polished Chrome 260			
	9BR7006-004 Polished Brass 003			
	9BR7006-005 Matte Antique Nickel 152			
	9BR7006-006 Matte Brass & Black 049			
BR7029 Wall Bumper 2.4" (Convex) 	9BR7029-001 Venetian Bronze 112	\$13.00	<ul style="list-style-type: none"> • Brass collar • Convex surface with durable rubber bumper for long operating life • Includes mounting hardware and installation instructions 	
	9BR7029-002 Satin Nickel 150			
	9BR7029-003 Polished Chrome 260			
	9BR7029-004 Polished Brass 003			
	9BR7029-005 Matte Antique Nickel 152			
	9BR7029-006 Matte Brass & Black 049			
BR7007 Wall Bumper 2.4" (Concave) 	9BR7007-001 Venetian Bronze 112	\$13.00	<ul style="list-style-type: none"> • Brass collar • Concave surface with durable rubber bumper for long operating life • Includes mounting hardware and installation instructions 	
	9BR7007-002 Satin Nickel 150			
	9BR7007-003 Polished Chrome 260			
	9BR7007-004 Polished Brass 003			
	9BR7007-005 Matte Antique Nickel 152			
	9BR7007-006 Matte Brass & Black 049			
BR7008 Floor Bumper .38" 	9BR7008-001 Venetian Bronze 112	\$13.50	<ul style="list-style-type: none"> • Solid brass shell • Stops door and prevents damage to wall and doors • Positive stopping action provided by non-marring bumper 	
	9BR7008-002 Satin Nickel 150			
	9BR7008-003 Polished Chrome 260			
	9BR7008-004 Polished Brass 003			
	9BR7008-005 Matte Antique Nickel 152			
	9BR7008-006 Matte Brass & Black 049			
BR7009 Floor Bumper .13" 	9BR7009-001 Venetian Bronze 112	\$13.50	<ul style="list-style-type: none"> • Designed for undercut doors or doors without threshold • Includes installation instructions and plastic anchor for concrete floor installation 	
	9BR7009-002 Satin Nickel 150			
	9BR7009-003 Polished Chrome 260			
	9BR7009-004 Polished Brass 003			
	9BR7009-005 Matte Antique Nickel 152			
	9BR7009-006 Matte Brass & Black 049			

	A	B	C
Floor Bumper .38"	1.77"	1.24"	1.12"
Floor Bumper .13"	1.77"	1.09"	1.12"

Item	Part Number	List Price	Specifications	Dimensions																				
HINGES																								
BR7023 3.5" 1/4" Radius 	9BR7023-001 Venetian Bronze 112 9BR7023-002 Satin Nickel 150 9BR7023-003 Polished Chrome 260 9BR7023-004 Polished Brass 003 9BR7023-005 Matte Antique Nickel 152 9BR7023-006 Matte Brass & Black 049	\$15.50	<ul style="list-style-type: none"> • Solid brass construction designed for residential door applications • Five knuckle, friction fit design with brass headed pin • Non-rising pin with hole in bottom tip for easy removal • Available as a complete set with mounting hardware • Ordered and packed one (1) hinge per box • Hinges ship dry to prevent chemical contamination on doors or wood jambs before finishing 	<div style="border: 1px solid black; padding: 5px; margin-bottom: 10px;"> Care & Maintenance <ul style="list-style-type: none"> • Recommended to lubricate hinge pin with heavy bearing grease • To lubricate, extract pin and wipe or dip with grease. Reinsert pin. Grease will work into load bearing surface. Wipe excess grease and dirt from hinge </div>  <table border="1" style="width: 100%; text-align: center;"> <thead> <tr> <th>A</th> <th>B</th> <th>C</th> <th>D</th> <th>E</th> </tr> </thead> <tbody> <tr> <td>.08"</td> <td>3.82"</td> <td>3.5"</td> <td>.25"</td> <td>1.86"</td> </tr> <tr> <td>.08"</td> <td>3.82"</td> <td>3.5"</td> <td>.625"</td> <td>1.86"</td> </tr> <tr> <td>.08"</td> <td>3.83"</td> <td>3.5"</td> <td>N/A</td> <td>1.86"</td> </tr> </tbody> </table>	A	B	C	D	E	.08"	3.82"	3.5"	.25"	1.86"	.08"	3.82"	3.5"	.625"	1.86"	.08"	3.83"	3.5"	N/A	1.86"
	A	B	C		D	E																		
	.08"	3.82"	3.5"		.25"	1.86"																		
	.08"	3.82"	3.5"		.625"	1.86"																		
	.08"	3.83"	3.5"		N/A	1.86"																		
	BR7024 3.5" 5/8" Radius 	9BR7024-001 Venetian Bronze 112 9BR7024-002 Satin Nickel 150 9BR7024-003 Polished Chrome 260 9BR7024-004 Polished Brass 003 9BR7024-005 Matte Antique Nickel 152 9BR7024-006 Matte Brass & Black 049	\$15.50		<ul style="list-style-type: none"> • Solid brass construction designed for residential door applications • Five knuckle, friction fit design with brass headed pin • Non-rising pin with hole in bottom tip for easy removal • Available as a complete set with mounting hardware • Ordered and packed one (1) hinge per box • Hinges ship dry to prevent chemical contamination on doors or wood jambs before finishing 																			
BR7025 3.5" Square 		9BR7025-001 Venetian Bronze 112 9BR7025-002 Satin Nickel 150 9BR7025-003 Polished Chrome 260 9BR7025-004 Polished Brass 003 9BR7025-005 Matte Antique Nickel 152 9BR7025-006 Matte Brass & Black 049	\$15.50	<ul style="list-style-type: none"> • Solid brass construction designed for residential door applications • Five knuckle, friction fit design with brass headed pin • Non-rising pin with hole in bottom tip for easy removal • Available as a complete set with mounting hardware • Ordered and packed one (1) hinge per box • Hinges ship dry to prevent chemical contamination on doors or wood jambs before finishing 																				
		BR7026 4" 1/4" Radius 	9BR7026-001 Venetian Bronze 112 9BR7026-002 Satin Nickel 150 9BR7026-003 Polished Chrome 260 9BR7026-004 Polished Brass 003 9BR7026-005 Matte Antique Nickel 152 9BR7026-006 Matte Brass & Black 049	\$17.00	<ul style="list-style-type: none"> • Solid brass construction designed for residential door applications • Five knuckle, friction fit design with brass headed pin • Non-rising pin with hole in bottom tip for easy removal • Available as a complete set with mounting hardware • Ordered and packed one (1) hinge per box • Hinges ship dry to prevent chemical contamination on doors or wood jambs before finishing 																			
			BR7027 4" 5/8" Radius 	9BR7027-001 Venetian Bronze 112 9BR7027-002 Satin Nickel 150 9BR7027-003 Polished Chrome 260 9BR7027-004 Polished Brass 003 9BR7027-005 Matte Antique Nickel 152 9BR7027-006 Matte Brass & Black 049	\$17.00	<ul style="list-style-type: none"> • Solid brass construction designed for residential door applications • Five knuckle, friction fit design with brass headed pin • Non-rising pin with hole in bottom tip for easy removal • Available as a complete set with mounting hardware • Ordered and packed one (1) hinge per box • Hinges ship dry to prevent chemical contamination on doors or wood jambs before finishing 																		
				BR7028 4" Square 	9BR7028-001 Venetian Bronze 112 9BR7028-002 Satin Nickel 150 9BR7028-003 Polished Chrome 260 9BR7028-004 Polished Brass 003 9BR7028-005 Matte Antique Nickel 152 9BR7028-006 Matte Brass & Black 049	\$17.00	<ul style="list-style-type: none"> • Solid brass construction designed for residential door applications • Five knuckle, friction fit design with brass headed pin • Non-rising pin with hole in bottom tip for easy removal • Available as a complete set with mounting hardware • Ordered and packed one (1) hinge per box • Hinges ship dry to prevent chemical contamination on doors or wood jambs before finishing 																	
					BR7011 Hinge Pin Door Stop 	9BR7011-001 Venetian Bronze 112 9BR7011-002 Satin Nickel 150 9BR7011-003 Polished Chrome 260 9BR7011-004 Polished Brass 003 9BR7011-005 Matte Antique Nickel 152 9BR7011-006 Matte Brass & Black 049	\$9.50	<ul style="list-style-type: none"> • Solid brass construction • Adjustable to stop door at any angle with rubber pad making contact with door • Hinge pin door stop can be used with Reserve hinges only. Not compatible with Baldwin Estate hinges. 	