

# Floor Type Door Bumpers

d

1

REVISION  
APR 2005

## SOLID BRASS CONSTRUCTION



No. 4000

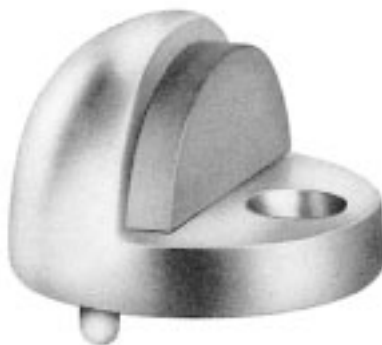

No. 4005



No. 4010

Item No.	Size Height	Dia.	Base Height	Packed per Box	Weight per Box	For Use With Threshold	O/A Height with 4207/4208 Riser	O/A Height with 4209/4210 Riser
4000	1" (25mm)	2" (51mm)	.187" (5mm)	50	12 lbs. (5.44kg)	-	1.5" (38mm)	1.75" (44mm)
4005	1.25" (32mm)	1.875" (48mm)	.375" (10mm)	40	16.6 lbs. (7.53kg)	.375" high (10mm)	1.75" (44mm)	2.0" (51mm)
4010	1.375" (35mm)	1.875" (48mm)	.5" (13mm)	40	19 lbs. (8.62kg)	5" high (13mm)	1.875" (48mm)	2.125" (54mm)

**FEATURES:** "Half Dome" design to minimize stumbling hazards and cleaning interference. Thick solid rubber bumper of special design is compounded for greater resiliency.

**PACKED:** Individually poly-bagged with appropriate fasteners in a dispensing type carton.

**FASTENERS:** Nos. 4000, 4005 and 4010 are supplied with fasteners for wood, plaster, and masonry installations.

**FEDERAL SPECIFICATION EQUIVALENTS:** Government Type: 1330/1330A  
BHMA Designation: L02141 (No. 4000)  
L02161 (No. 4005/No. 4010)

**REPLACEMENT RUBBER:** No. 4000.406 for 4000/4005/4010

## RISERS FOR FLOOR BUMPERS

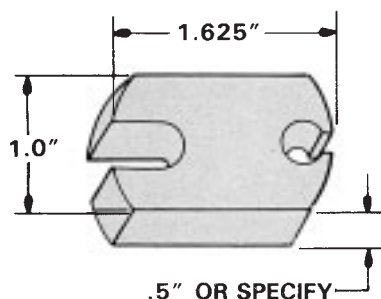

Item No.	Riser Height	Fasteners	Packed per Box	Weight per Box
4207	.5" (13mm)	No. 14 × 1.5" wood screw	25	2.5 lbs. (1.13kg)
4208	.5" (13mm)	¼-20 × 1.75" machine screw	25	2.5 lbs. (1.13kg)
4209	.75" (19mm)	No. 14 × 1.5" wood screw	25	3.3 lbs. (1.50kg)
4210	.75" (19mm)	¼-20 × 1.5" machine screw	25	3.5 lbs. (1.59kg)

**FEATURES:** Made for use on carpeted floors. Only an "X" cut is required in the carpet to install the riser. The pile of the carpet will form around the riser and fill in under the bumper, concealing the installation. Made of extruded aluminum; mill finish. When ordered separately, risers are furnished with fasteners, plated to match door bumpers.

**PACKED:** Individually poly-bagged with appropriate fastener.

**ORDERING INSTRUCTIONS:** To determine overall bumper height with riser, refer to door bumper chart. RISERS ARE DESIGNED TO FIT ALL NO. 4000 SERIES FLOOR BUMPERS. ALWAYS SPECIFY FLOOR CONDITION AND FINISH FOR PROPER FASTENER.

**NOTE:** Always specify finish of fasteners required.

# Universal Stops and Bumpers

## SOLID BRASS CONSTRUCTION



No. 4510

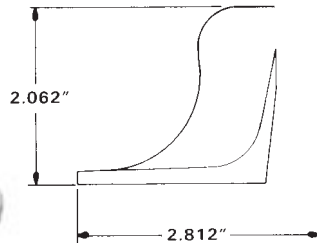

**FEATURES:** Forged construction floor bumper is designed for use on doors with or without thresholds. Modern and streamlined shape reduces obtrusive appearance. High projection obviates the use of inventorying different heights of floor bumpers.

**PACKED:** No. 4510: One in a box with wood and masonry fasteners.

**WEIGHT EACH:** .6 lb. (.27kg)

**BHMA DESIGNATION:** L02181

**REPLACEMENT RUBBER:** No. 4510.406

## WALL TYPE FLUSH BUMPER



No. 4015

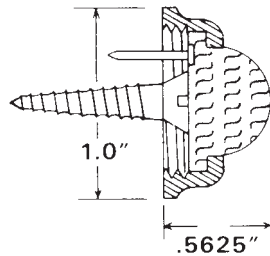

**SIZE:** Diameter: 1" (25mm). Projection: .562" (14mm).

**FEATURES:** Compact designed bumper permits installation in areas where larger bumpers are not suitable due to size or projection. Fasteners are totally concealed underneath durable rubber insert.

**PACKED:** 20 in a box, individually poly-bagged with appropriate fasteners.

**WEIGHT PER BOX:** .8 lb. (.36kg)

**REPLACEMENT RUBBER:** No. 4015.406

# Wall Type Flush Bumpers

d

3

REVISION  
APR 2005

## CONCEALED SCREW ATTACHMENT—CONVEX DESIGN

**SIZE:** Outside diameter: 1.75" (44mm). Projection: 1" (25mm).

**FEATURES:** Engineered for commercial/residential installations, this compact and contemporary designed bumper features completely concealed fasteners for an unobtrusive and screwless appearance. Supplied with wood and masonry fasteners, it is furnished unassembled to facilitate the substitution of fasteners. Designed for ease of installation, the bumper is attached onto a heavy gauge metal back plate through a threading application. For a fully theft proof installation, the use of a strap wrench for tightening or several drops of Loctite Grade A is recommended.

**PACKED:** 50 in a box; individually poly-bagged with appropriate fasteners in a dispensing type carton.

**WEIGHT PER BOX:** 10 lbs. (4.54kg)

**FEDERAL SPECIFICATION EQUIVALENTS:**

Government Type: 1327  
BHMA Designation: L02101

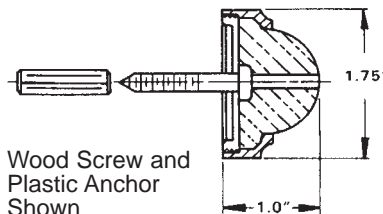

No. 4252

## CONCEALED SCREW ATTACHMENT—CONCAVE DESIGN

**SIZE:** Outside diameter: 1.75" (44mm). Projection: 1" (25mm).

**FEATURES:** Concave type rubber permits knob of button type lock to strike bumper without engaging lock mechanism. Special design protects lock mechanism from damage.

**PACKED:** 50 in a box; individually poly-bagged with wood and masonry fasteners in a dispensing type carton.

**WEIGHT PER BOX:** 9.6 lbs. (4.35kg)

**FEDERAL SPECIFICATION EQUIVALENTS:**

Government Type: 1327  
BHMA Designation: L02251

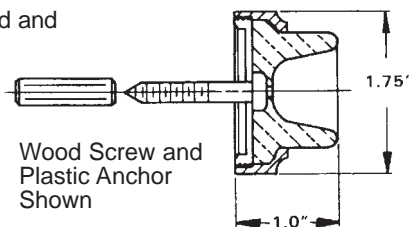

No. 4273

## CONCEALED SCREW ATTACHMENT—CONCAVE DESIGN

**SIZE:** Diameter: 2.375" (60mm). Projection: 1" (25mm).

**FEATURES:** Concave type rubber permits knob of button type lock to strike bumper without engaging lock mechanism. Special design protects lock mechanism from damage.

**PACKED:** 25 in a box; individually poly-bagged with wood and masonry fasteners in a dispensing type carton.

**WEIGHT PER BOX:** 4.5 lbs. (2.04kg)

**BHMA DESIGNATION:** L22251

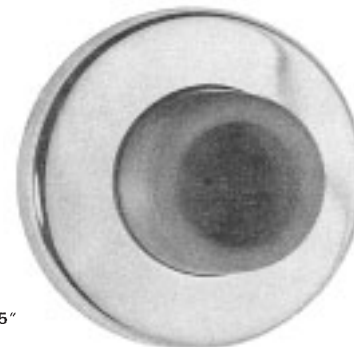
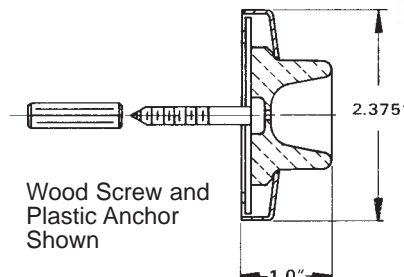

No. 4293

# Base Mounted Door Bumpers

## SOLID FORGED BRASS CONSTRUCTION



No. 4045

No. 4050

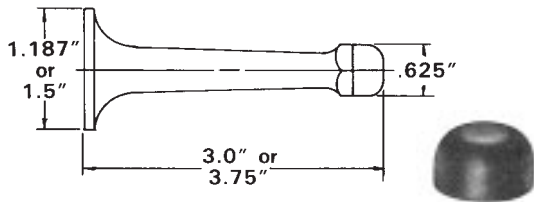

**SIZE:** No. 4045: Base Diameter: 1.1875" (30mm). Projection: 3" (76mm).  
No. 4050: Base Diameter: 1.5" (38mm). Projection: 3.75" (95mm).

**FEATURES:** Solid forged brass construction for maximum strength and durability. Stem of bumper has hexagon section to facilitate fastening without damaging finish. Resilient rubber guard is replaceable.

**PACKED:** 10 in a box; individually poly-bagged with appropriate fasteners.

**WEIGHT PER BOX:** No. 4045: 2 lbs. (.91kg). No. 4050: 3 lbs. (1.36kg)

**FASTENERS:** Nos. 4045 and 4050 Bumpers are supplied with wood screw thread.

**FEDERAL SPECIFICATION EQUIVALENTS:**

Government Type: 1332

BHMA Designation: L02031

**No. 4041** Replacement Tips available packed 10 per poly bag.

## SOLID FORGED BRASS CONSTRUCTION



No. 4055

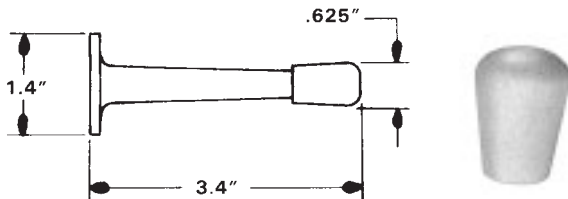

**FEATURES:** Identical construction as No. 4045 series with streamlined shape. Designed for quick and efficient installation by power driven tools, using socket type wrench. Resilient rubber guard is replaceable.

**PACKED:** 10 in a box; individually poly-bagged with appropriate fasteners.

**WEIGHT PER BOX:** 1.9 lbs. (.86kg)

**FASTENERS:** No. 4055 is supplied with wood screw thread.

**FEDERAL SPECIFICATION EQUIVALENTS:**

Government Type: 1322

BHMA Designation: L02031

**No. 4057** Replacement Tips available packed 10 per poly bag.

# Door Stops and Holders

## FORGED BRASS LEVER TYPE DOOR HOLDER

**SIZE:** No. 4100: Length of Arm: 4" (102mm). Maximum Floor Clearance: 3" (76mm). No. 4105: Length of Arm: 5" (127mm). Maximum Floor Clearance: 4" (102mm).

**FEATURES:** Forged Brass construction incorporating a stainless steel hinging pin for added strength. This holder can be operated by foot. Highest quality non-marring rubber tip grips floor and holds the door at any desired opening. A spring catch holds the lever in an upright, disengaged position when holder is not in use. Specially designed rubber shoe will not loosen in service but can easily be replaced.

**PACKED:** 10 in a box; individually poly-bagged with appropriate fasteners.

**WEIGHT** Per Box: No. 4100: 4.4 lbs. (2kg). No. 4105: 5 lbs. (2.27kg).

**FASTENERS:** Furnished standard with sheet metal screws.

**FEDERAL SPECIFICATION EQUIVALENTS:**

Government Type: 1149A/1149B  
BHMA Designations: L01391 (4100)  
L01381 (4105)

**No. 4101** Replacement Tips available packed 10 per poly bag.



## UNIVERSAL FLOOR BUMPER

**SIZE:** Height: 1.5" (37mm). Diameter: 1.187" (30mm)

**FEATURES:** Designed for concealed mounting applications, this contemporary floor bumper contains the mounting screw within the body of the bumper. The rubber insert is located .798" (20mm) from the bottom to function on doors with a .375" (9.5mm) to a 1" (25mm) undercut. To facilitate the replacement of the rubber guard, simply remove the top cap.

**PACKED:** 10 in a box, individually poly-bagged with appropriate fasteners.

**WEIGHT PER BOX:** 4 lbs. (1.8kg).

**FASTENERS:** Supplied with a wood screw and plastic anchor.

**No. 4507** Replacement rubber inserts available packed 10 per poly bag.

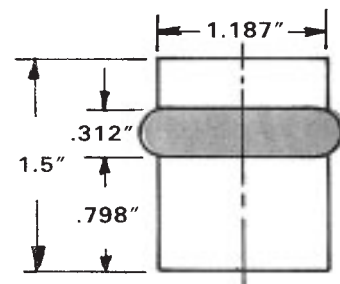

**d**

**6**

REVISION  
APR 2005

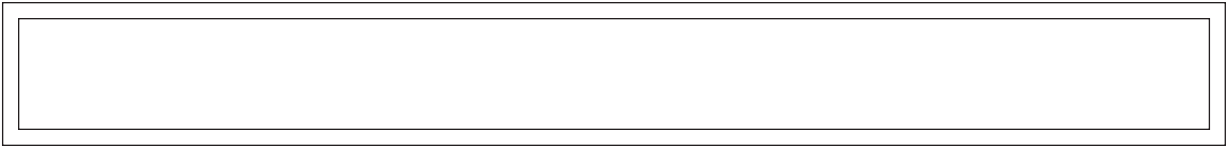

**RESERVED FOR  
FUTURE ADDITIONS**